

Monday

Tuesday

Wednesday

Thursday

Friday

Saturday

	A	B	C	D
9am	Level Key Beg & Level I = No Exp Needed Level I/II = No Exp to 1-2yrs Training Previous training required or assessment needed for the following levels. Level II Level III Level IV Level V Level VI Level VII			
10am				
11am				
12pm				
1pm				
2pm				
3pm				
4pm	Jazz I 4-5pm 5-8yrs LR	Hip Hop II 4-5pm 8yrs+ NC	Contemp V/VI 4-5pm 12yrs+ MR	Acrobatics III 4-5pm 8-13yrs VD
5pm	Company 5-5:30pm	Crew 5-5:30pm	Company 5-5:30pm	Company 5-5:30pm
6pm	Tap V 5:30-6:30pm 11yrs+ LR/CM	Tap VI 5:30-6:30pm 14yrs+ CM/LR	Jazz IV 5:30-6:30pm 9-15yrs RR	Acrobatics II 5:30-6:30pm 6-12yrs VD
7pm	Tap I/II 6:30-7:30pm 9yrs+ SW	Company 6:30-7pm	Jazz III 6:30-7:30pm 8-13yrs RR	Acrobatics IV 6:30-7:30pm 9-15yrs VD
8pm	Teen/Adult Tap 7:30-8:30pm 16yrs+ SW	Ballet VI/VII 7-8:15pm 12yrs+ GA/EB	Company 7:30-8pm	Pointe I* 8:15-8:45pm GA/EB
9pm				

	A	B	C	D
10am				
11am				
12pm				
1pm				
2pm				
3pm				
4pm	Breaking I 4-5pm 6yrs+ NC	Tap I 4-4:45pm 5-8yrs LR	Stu Styles Tech Z 3-4:30pm 15yrs+ MR	Voice 4-5pm 8yrs+ IM
5pm	Hip Hop I (Beg) 5-6pm 6-9yrs NC	Ballet I 4:45-5:30pm 5-8yrs LR	Contemp VI/VII 4:30-5:30pm 12yrs+ MR	Little Shop of Horrors* 5-7pm 7yrs+ PR
6pm	Crew 6-6:30pm	Breaking II 5:30-6:30pm 8yrs+ OG	Jazz VI/VII 5:30-6:30pm 12yrs+ MR	
7pm	Hip Hop I (Tween/Teen) 6:30-7:30pm 10yrs+ NC	Ballet V 7-8:15pm 11yrs+ GA	Breaking III/IV 6:30-7:30pm 12yrs+ OG	
8pm	Choreography Beg/Int 7:30-8:30pm 10yrs+ NC	Pre-Pointe* 8:15-8:45pm GA	Choreography 7:30-8:45pm 13yrs+ LR	

	A	B	C	D
10am				
11am				
12pm				
1pm				
2pm				
3pm				
4pm	Acro VI/VII 3-4pm 14yrs+ OG/VD	Company 3:30-4pm		
5pm	Acro V/VI 4-5:30pm 12yrs+ OG/VD	Tap II 4-5pm 6-11yrs LR	Jazz I 4-5pm 5-8yrs MC	Acrobatics I 4-5pm 5-8yrs VD
6pm	Ballet I 5:30-6:30pm 5-8yrs GA	Contemp II 5:30-6:30pm 6-11yrs LR	Waacking II/III 5-6pm 10yrs+ JN	Popping I/II 5-6pm 8yrs+ PT/NC
7pm	Crew 6:30-7pm	Company 6:30-7pm	Waacking I/II 6-6:30pm 8yrs+	Popping II/III 6-7pm 10yrs+ PT/NC
8pm	Tap IV 7-8pm 9-14yrs LR	Ballet V-VII 7-8:15pm 12yrs+ GA	Waacking III/IV 7-8pm 13yrs+ JN	Hip Hop III 7-8pm 10yrs+ NC
9pm				

	A	B	C	D
10am				
11am				
12pm				
1pm				
2pm				
3pm				
4pm	Contemp III 4-5pm 8-13yrs LR	Ballet II 4-5pm 7-11yrs JT	Intro to Street Styles 4-4:45pm 5-8yrs NC	Jazz V/VI 4-5:15pm 12yrs+ MR
5pm	Jazz II 5-6pm 7-11yrs LR	Company 5-5:30pm	Crew 4:45-5:15	House Int/Adv 5:15-6:15pm 13yrs+ D
6pm	Ballet IV 6-7pm 9-15yrs MR	Ballet III 6-7pm 8-13yrs ST	Hip Hop IV 5:15-6:15pm 9-15yrs NC	House Beg/Int 6:15-7:15pm 8-15yrs D
7pm	Tap III 7-8pm 8-13yrs LR	Contemp IV 7-8pm 9-15yrs MR	Hip Hop V/VI 6:15-7:30pm 13yrs+ NC	Company 7:15-7:45pm
8pm	Company 8-8:30	Crew 8-8:30pm		

	A	B	C	D
10am				
11am				
12pm				
1pm				
2pm				
3pm				
4pm	Aerial Silks + 4:30-6pm 8-12yrs RR	Ballet I 4-4:45pm 5-8yrs MD	PBT 5/6 4:15-5:15pm 12yrs+ MR	Ballet I/II 4:15-5:15pm 9-17yrs ML
5pm	Aerial Silks + 6-7:30pm 12yrs+ RR	Jazz I 4:45-5:30pm 5-8yrs MD	Stu Styles Tech 5/6 5:15-6:15pm 12yrs+ MR	Jazz I/II 5:15-6:15pm 9-17yrs ML
6pm	Contemp I/II 5:30-6:15pm 6-11yrs MD	Acrobatics I/II 6:15-7:15pm 6-11yrs VD	PBT 3/4 6:15-7:15pm 9yrs+ MR	Stu Styles Tech 3/4 7:15-8:15pm 9yrs+ MR

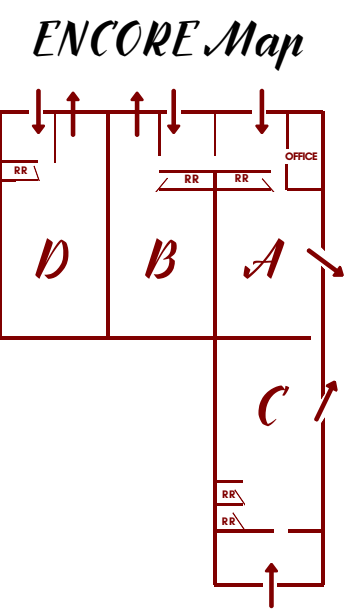

Acrobatics I 10-11am 4-6yrs RR	Creative Movement 10:15-11am 2-4yrs KM
Acrobatics I/II 11-12pm 6-9yrs RR	Ballet Beg 11-11:45am 3-5yrs KM
	Tap Beg 11:45-12:30pm 3-5yrs KM

- Class Information:**
- Ages listed are guidelines only. Some students (based on skills) may be able to join classes outside the age range. Inquire via email for an assessment.
 - Our prerequisites, class etiquette, class descriptions, style attire and instructor bios are on our website.
 - An * indicates that a previous class is required in order to register.
 - Our classrooms are strictly for students & instructors only, thus allowing for a more focused learning environment.
 - Grayed out classes are audition only; inquire via email for a private audition.

*Little Shop of Horrors is a separate program fee of \$90 monthly.

Calendar Highlights

see our website for details on all ENCORE happenings; click 'Calendar'

September '23

- 5 - Fall/Spring S.13 "Amplify" Begins
- 16-17: Weekend of Dance Fundraiser

October '23

- 28th - October Moon Festival & Youth Kids Battle

November '23

- 22nd - 25th - ENCORE Closed

December '23

- 18th - 30th - ENCORE Closed

January '24

- 1st - Classes Resume
- 30th - Little Shop Costume Fee Auto-Process

February '24

- 6th - Recital S.13 Costume Fee Auto-Process

March '24

- 25th - 30th - ENCORE Closed

April '24

- 12-14 - Company & Crew Showcase Performance

May '24

- 10-12 - Little Shop of Horrors Musical Theatre Performance
- 25/26 - Season 14 Auditions

June '24

- TBA - 13th Annual Dance Recital "Amplify"
- 22 - S13 Ends

BE MORE ENCORE

PERFORMING ARTS CENTER

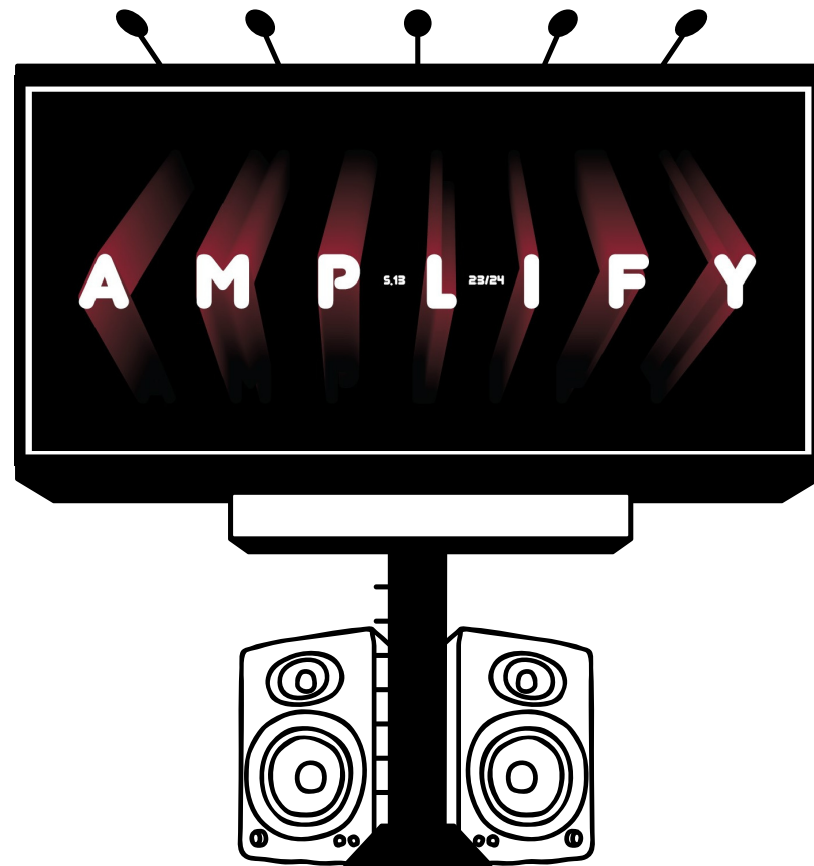

SEPT 5 - JUN 22

ENCORE Hours:
M-F 9a-9pm
Sat 9a-12pm

Office Hours:
M-F
9a-1pm

REV 4



@encorepacnw

ENCORE Performing Arts Center
7700 SW Nimbus Ave. Bldg 10
Beaverton, Oregon 97008

info@encorepacnw.com
www.encorepacnw.com
503-608-7207

Quick Response: Text Us!

enCORE DETAILS:

Registration

Registration can be completed online at www.encorepacnw.com, in person, or via email at info@encorepacnw.com. An annual member fee of \$25 per student/\$40 per family is due upon registration. Once a student is registered, we consider them enrolled to the end of our season in June. (See season dates on front cover) Enrollment into the correct level is required. We anticipate our classes will fill and encourage you to add yourself to any waitlist(s) to get into our program(s). Any schedule changes will be noted by the revision updates located on the front of our brochure.

Tuition

Placement in a class is only guaranteed when accompanied by your first tuition payment. All remaining tuition payments will be processed on the third Tuesday of the month. At ENCORE we process tuition ahead of instruction, therefore, your last payment will occur in May although our instruction will continue in June. You will receive an invoice after each processing date. A \$10 fee will occur for late payments. Returned checks will be charged \$25.

Tuition consists of a fixed monthly charge. There will be 3 to 5 classes per month. On average throughout the season there will be 4 classes per month and the monthly charge will not change. Tuition is not a pay-by-class rate and will not be pro-rated due to vacations, holidays, pre-scheduled closures or absences. This includes classes missed or canceled due to bad weather, instructor illness, etc. No refunds or pro-rates will be issued.

Any/all missed classes can be made up during the current season (Sept - Jun) in a class of your choosing. Submit via email: info@encorepacnw.com

Cancellation Policy

ENCORE reserves the right to cancel and/or combine classes in the schedule depending on demand and registration. If ENCORE cancels a class for the entire season and we cannot find a comparable class for your student, the tuition will be refunded. In order to withdraw from a class, you must submit a form via the website. Click 'classes' than 'cancelation form' before the tuition processing date (third Tuesday of the month). You are responsible for any fees charged prior to your notice. You may switch classes within the season one-time. No one is allowed to switch (recital) classes after February 1st (unless by instructor approval) as classes are focused on choreography and formations for recital.

Monthly Tuition Chart*

*See Tuition Info Above

30 min	\$30	3.5 hrs	\$198	6.5 hrs	\$282
45 min	\$45	3.75 hrs	\$208	6.75 hrs	\$286
1 hr	\$60	4 hrs	\$218	7 hrs	\$290
1.25 hrs	\$75	4.25 hrs	\$226	7.25 hrs	\$298
1.5 hrs	\$90	4.5 hrs	\$234	7.5 hrs	\$306
1.75 hrs	\$105	4.75 hrs	\$242	7.75 hrs	\$314
2 hrs	\$120	5 hrs	\$250	8 hrs	\$322
2.25 hrs	\$135	5.25 hrs	\$256	8.25 hrs	\$331
2.5 hrs	\$149	5.5 hrs	\$262	8.5 hrs	\$339
2.75hrs	\$164	5.75 hrs	\$268	8.75 hrs	\$347
3 hrs	\$178	6 hrs	\$274	9 hrs	\$355
3.25 hrs	\$188	6.25 hrs	\$278	Unlimited	\$365

Drop In Pricing

All drop-ins are on a first come, first served basis.

45m.....	\$15
1h.....	\$18
1.5h.....	\$22
1st Trial Class....	FREE

*Musical Theatre is a flat rate of \$90 monthly and is not included in our season tuition chart. Musical theatre runs to the end of our season with an excerpt in our annual recital.

Recital Fee

Our end of season recital "AMPLIFY" will be held in June.

Recital students/classes will be auto-charged a costume fee of up to \$65 per class, per student. Students may be asked to purchase additional items such as shoes, tights, jewelry and the like to complete the full look. All costumes are yours to take home after recital.

Fees auto-charged: February 6th. Costumes must be paid in full before the student is able to receive these items. We are unable to offer any refunds for recital costume costs.

More information will be coming later in the season.

Little Shop (MT) Musical Theatre

Little Shop the Musical will be taking the stage!

Join our musical theatre classes on Tuesdays. No experience, or audition is necessary for registration. Students will learn acting skills, audition skills, and how to dance/sing while building confidence to take the stage. In-class auditions will occur in early October and each student will receive a part in the musical. Costume fee (\$75) will be auto-processed on Jan 30th.

Students will take the stage on May 10-12th at the Sherwood Center for the Arts. It's time for you to SHINE!

Our musical theatre program is \$90 a month and is not included in our sliding scale payment structure.